

Data sheet

ID	GDG
Description	outlet box, single gang, halogen-free
Properties	with 4 mounting lugs, standard mounting screw spacing 60 mm, exit opening Ø 60 mm, interlinkable in 71 mm distance, installation height 57.5 mm, max. 2 conduit entries up to Ø 25 mm main box part GDGM, fixing base BFD 60, bottom lid BOD 60
Colour	orange, similar to RAL 2004 green, similar to RAL 6029

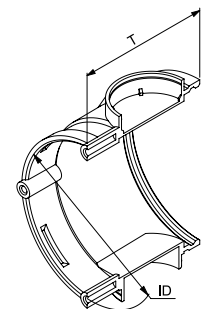

Halogen free

True

Degree of protection (IP)

IP30

Art. no.	Dimensions Ø/LxB x T	Small Package	Large Package
026 310	Ø 60 x 58 mm	5 pc	50 pc

Further technical details

Details	
break-out opening	True
seal membrane	False
nozzle	False
step membrane	False
Mounting switching equipment	Screwing
Luminaire hook mounting	False
Nozzle	None
With nail lugs	False
Circuit integrity	None

Details	
Model	Single
Shape	Round
Mounting method	Concrete building
With screws	False
Provided with revolving ring	False
Connectable	True
Equipped with	None
Cover attachment	Snap on
Material	PE