

Data sheet

Part No. SD

Description wall outlet box, single gang, halogen-free
with 4 mounting lugs, standard mounting screw spacing 60 mm, exit opening Ø 60 mm, interlinkable in 71 mm distance, installation height 49 mm, max. 2 conduit entries up to Ø 25 mm
main box part SDH with integrated bottom, fixing base BFD 60

Colour orange, similar to RAL 2004

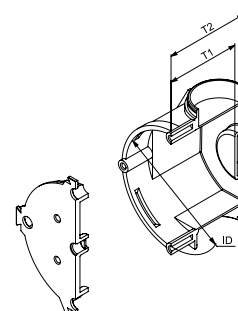

Halogen free
True

Degree of protection (IP)
IP30

Art. no.	Dimensions	ps	pl
026 294	Ø 60 x 49 mm	5 pc	50 pc

Areas of Recommended Application

Area	
break-out opening	True
seal membrane	False
nozzle	False
step membrane	False
Mounting switching equipment	Screwing
Luminaire hook mounting	False
Nozzle	None
With nail lugs	False
Circuit integrity	None

Further technical details

Details	
Model	Single
Shape	Round
Mounting method	Concrete building
With screws	False
Provided with revolving ring	False
Connectable	False
Equipped with	None
Cover attachment	Snap on
Material	PE