

PCE data sheet

article#	96061552
article description	CEE-wall mounted socket COMBO-POL 16A 5p 6h IP44
description long	CEE-wall mounted socket COMBO-POL 16A 5p 6h IP44 housing material: PA6 rated current: 16A number of poles: 5 (3P+N+PE) clock-position: 6h rated voltage/frequency: 200/346V~ - 240/415V~ / 50+60Hz contacts: brass nickel plated connection technology: screw terminals cable entry: top or rear with ON/OFF (0-I) switch AC22A with 2x safety socket 16A 250V (Austrian/German system) IP protection class: IP44
GTIN (EAN)	9003399566400
country of origin	PL
customs number	85366990
net weight	0.800 kg
packaging quantity	1

ETIM 7.0	EC001324
IEC-amperage	16 A
Number of poles	5
Voltage acc. EN 60309-2	400 V (50+60 Hz) red
Clock hour position	6 h
Identification colour	Red
Degree of protection (IP)	IP44
Switch	With on/off switch, without locking
Material housing	Plastic

wire flexible	1-2,5 mm ²
wire solid	1-4 mm ²
contact screws	100 Ncm
dismantling length	50 mm
stripping length	10-12 mm

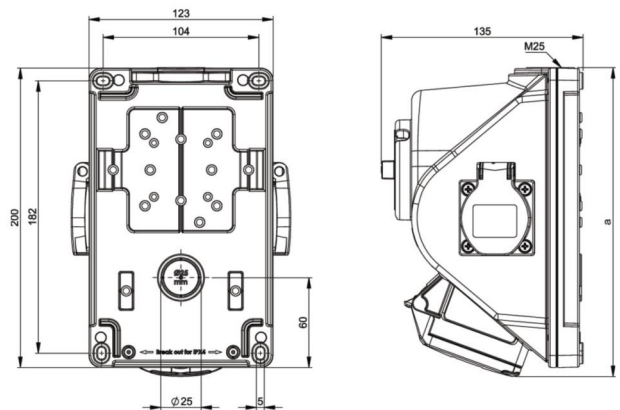

www.manufacturer-safety.info